

RYMSA RF manufactures coaxial fine matchers for outdoor applications in several line sizes (indoor version also available).

The outdoor units are normally employed in the interface between an antenna system and its feeder line to optimize the impedance matching between them.

## Technical Specifications

Frequency range		See table below
Impedance		50 Ohm
Insertion loss		Negligible
Maximum power handling		According to line size
Materials	Outer conductor	Copper
	Inner conductor	Copper or silver plated aluminium
	Isolators	PTFE
	Finishing	Long lasting grey paint
Temperature range		-40°C to +80°C

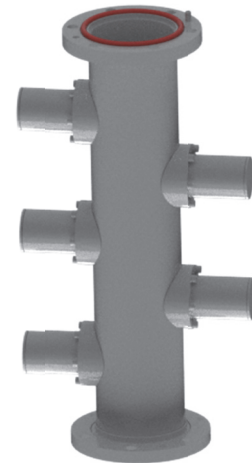

## Models

Description	Frequency range	Model
EIA 1 5/8" flanged male	Band II	SF12-400
EIA 1 5/8" flanged female	Band II	SF12-410
EIA 3 1/8" flanged female	Band II	SF12-610
EIA 3 1/8" flanged male	Band III	SF13-610
EIA 1 5/8" flanged male	Band IV-V	SF15-410
EIA 3 1/8" flanged male	Band IV-V	SF15-610
IEC 4 1/2" flanged male	Band IV-V	SF15-510
EIA 6 1/8" flanged male	Band IV-V	SF15-910

**Other models not displayed in this table are available under request**